

CAST STEEL GLOBE & CHECK VALVES

CARBON STEEL, ALLOY STEEL, STAINLESS STEEL & EXOTIC ALLOY VALVES



CREATE FAMOUS BRAND FOR INTERNATIONAL INDUSTRY.



www.panchvalves.com



**PANCHVATI VALVES
& FLANGES PVT. LTD.**

Customer Trust Built on Quality
Since - 1991

CAST STEEL GLOBE VALVES CONSTRUCTION FEATURES

- Valves Code BS 1873
- End to end Dimension ANSI B 16. 10/2080
- End Flanged Flat / Raised Face , drilled to ANSI B 16.5/ BS 1560
- Bonnet Bolted
- Stem Rising
- Disc Loose Plug
- Seat Seal Welded / Renewable - Screwed
- Stem Packing Renewable with valve open on stream
- Testing Code MSS SP 61/ BS 6755 / API 598
- Handwheel rising
- Others Outside screw and yoke

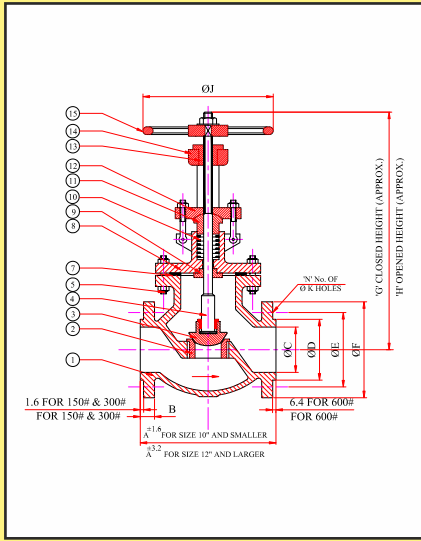

MATERIAL SPECIFICATION					
NO.	COMPONENT	CAST CARBON STEEL	CAST ALLOY STEEL	CAST STAINLESS STEEL	
1.	Body	ASTM A216 GR WCB	ASTM A217 C-5 / C12	ASTM-A 351 GR CF8	ASTM A 351 GR CF 8M
2.	Seating	13% CR Steel		AISI 304 / ASTM - A	AISI 316 / ASTM A
3.	Disc	13% CR Steel 13% CR steel hard facing On Body material		A 351 GR CF8	A 351 GR CF8M
4.	Stem/Spindle	AISI 410		AISI 304	AISI 316
5.	Bonnet Stud	ASTM A 193 GR B7		ASTM A 193 GRB8	ASTM A 193 GRB 8 M
6.	Bonnet Stud Nut	ASTM A 194 GR 2H		ASTM A 194 GR 8	AST A 194 GR 8M
7.	Gasket	CAF / Spiral wound Metallic SS 304 / SS 316 Filled with Asbestos / Graphite			
8.	Bonne	ASTM A216 GR WCB	ASTM A217 C-5/C-5/C-12	ASTM-A 351 GR CF 8 ASTM	A 351 GR CF 8M
9.	Bonnet Bush	AISI 410		AISI 304	AISI 316
10.	Packing	Machine Braided Metallic Reinforced Asbestos			
11.	Gland Bush	AISI 410		AISI 304	AISI 316
12.	Gland Flange	Carbon Steel		ASTM A 351 GR CF8 / AISI 304	ASTM A 351 GR CF8M / AISI 316
13.	Yoke Sleeve	NI-Resist Nodular Cast Iron - ASTM A 439 Gr D - 2			
14.	Yoke Bush	Carbon Steel		Carbon Steel (Plated)	
15.	Handwheel	Malleable Iron / C. Iron / Carbon Steel			

TEST PRESSURE							
HYDROSTATIC TEST							
Material	Class	Shell		Seat		Air Seat Test	
		PSIG	KSCG	PSIG	KSCG	PSIG	KSCG
A 216 GR, WCB AND A 217 C5 /C12	150	450	31.64	325	22.88	80-100	6-7
	300	1125	79.09	825	57.80	80-100	6-7
	600	2250	158.18	1650	116.00	80-100	6-7
A 351 CF 8 / CF8C AND A 351 CF 8 M	150	425	29.88	305	21.44	80-100	6-7
	300	1100	77.33	800	56.24	80-100	6-7
	600	2175	152.9	1600	112.5	80-100	6-7

DIMENSIONS														
Class	Size	mm	50	80	100	150	200	250	300	350	400	450	500	600
150	A	mm	203	241	292	406	495	622	698	787	916	977	977	1295
	G	mm	355	406	472	514	570	680	845	1010	1240	1270	1320	1420
	H	mm	375	432	508	566	626	750	950	1145	1270	1300	1350	1450
	J	mm	203	254	254	356	457	559	610	610	650	650	700	750
	B	mm	16	19	24	25	29	30	32	35	37	38.1	41.3	46.1
	C	mm	51	76	102	152	203	254	305	337	307	438	489	591
	D	mm	92	127	157	216	270	324	381	413	470	533.4	584	692
	E	mm	121	152	190	241	298	362	432	476	540	570	635	749.3
	F	mm	152	190	229	279	343	406	483	533	597	635	698.5	812.8
300	K	mm	19	19	19	22	22	25	25	29	28.6	31.8	31.8	41.3
	N	nos	4	4	8	8	8	12	12	12	16	16	20	20
	A	mm	267	318	356	444	559	622	711	838	863	977	1016	1346
	G	mm	390	498	526	603	915	1042	1060	1220	1200	1305	1355	1445
	H	mm	410	524	562	648	940	1067	1085	1250	1295	1340	1385	1475
	J	mm	203	254	357	457	559	610	700	700	450	500	550	550
	B	mm	22	29	32	37	41	48	51	54	55.6	58.8	61.9	68.3
	C	mm	51	76	102	152	203	254	305	337	387	438	489	591
	D	mm	92	127	157	216	270	324	381	413	470	533.4	584	692
600	E	mm	127	168	200	270	330	387	451	514.3	592	628.6	685.8	812.8
	F	mm	165	210	254	318	381	445	521	584.2	648	711.2	774.7	914.4
	K	mm	19	22	22	22	25	29	32	32	35	36	36	41.3
	N	nos	8	8	8	12	12	16	16	20	20	24	24	24
	A	mm	292	356	432	559	660	787	838					
	G	mm	419	500	523	724	1150	1289	1300					
	H	mm	438	525	557	780	1175	1314	1320					
	J	mm	254	356	356	610	610	610	400					
	B	mm	25	32	38	48	56	64	667					
C	mm	51	76	102	152	200	248	299						
D	mm	92	127	157	216	270	324	381						
E	mm	127	188	216	292	349	432	489						
F	mm	165	210	273	356	419	508	559						
K	mm	19	22	25	29	32	35	38						
N	nos	8	8	8	12	12	16	20						

CAST STEEL CHECK VALVES CONSTRUCTION FEATURES

- Type Swing Check
- Valve Code Bs 1868
- End to End Dimension
ANSI B16.10/ Bs 2080
- End Flanged Flat/Raised Face, drilled to
ANSI B 16.2/BS 1560
- Cover Bolted
- Disc Hinged
- Seat Seal Welded / Renewable - Screwed
- Testing Code MSS SP 61 / BS 6755 /
API 598

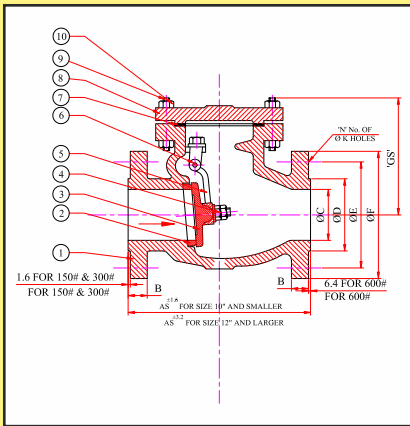

MATERIAL SPECIFICATION

NO.	COMPONENT	CAST STAINLESS STEEL			
		CAST CARBON STEEL	CAST ALLOY STEEL	ASTM-A 351 GR CF8	ASTM A 351 GR CF 8M
1.	Body	ASTM A216 GR WCB	ASTM A217 C-5 / C12	ASTM-A 351 GR CF8	ASTM A 351 GR CF 8M
2.	Seating	13% CR Steel		ASTM-A 351 GR CF8	ASTM A 351 GR CF 8m
3.	Disc	13% CR Steel / facing on body material		AISI 304	AISI 316
4.	Disc Nut	AISI 410	AISI 410	AISI 304	AISI 316
5.	Hinge	A 216 WCB	A 217 CA 15	A 351 CF 8	A 351 CF 8M
6.	Hinge Pin	AISI 410	AISI 410	AISI 304	AISI 316
7.	Gasket	CAF / Spiral wound Metallic SS 304 / SS 316 GR CF8 Filled with Asbestos / Graphite			
8.	Cover	ASTM A 216GR WCB	ASTM A 217 C-5	ASTM A 351 GR CF8	ASTM A 351 GR CF8M
9.	Cover Stud	A 193 B-7	A 193 B-7 / B 16	A 193 B -8	A 193 B 8M
10.	Cover Stud Nut	A 194 2H	A 194 2H / Gr6	A 194 GR 8	A 194 GR 8M

TEST PRESSURE

HYDROSTATIC TEST							
Material	Class	Shell				Hydrostatic Seat	
		PSIG	KSCG	PSIG	KSCG	PSIG	KSCG
A 216 GR. WCB AND A 217 C5 / C12	150	450	31.64	325	22.88	78.75	5.54
	300	1125	79.09	825	57.80	203.75	14.33
	600	2250	158.18	1650	116.00	407.5	28.66
A 351 CF 8 / CF8C AND A 351 CF 9 M	150	425	29.88	305	21.44	65	4.57
	300	1100	77.33	800	56.24	169	11.86
	600	2175	152.9	1600	112.5	326.25	22.90

DIMENSIONS

Size	mm	50	80	100	150	200	250	300	350	400	450	500	600
		GS	mm	203	241	292	356	495	622	699	787	864	977
B	mm	153	188	213	282	340	396	464	542	542	570	625	675
B	mm	16	19	24	25	29	30	32	35	37	35	41.3	46.1
C	mm	51	76	102	152	203	254	305	337	387	438	489	591
D	mm	92	127	157	216	270	324	381	413	470	533.4	584	692
E	mm	121	152	190	241	298	362	432	476	540	578	635	749.3
F	mm	152	190	229	279	343	406	483	533	597	635	698.5	812.8
K	mm	19	19	19	22	22	25	25	29	29	31.8	31.8	35
N	nos	4	4	8	8	8	12	12	12	16	16	20	20
AS	mm	267	318	356	444	533	622	711	838	863	977	1016	1346
GS	mm	194	220	245	300	364	418	460	562	545	605	675	785
B	mm	22	29	32	37	41	48	51	54	55.6	58.8	61.9	68.3
C	mm	51	76	102	152	203	254	305	337	387	438	489	591
D	mm	92	127	157	216	270	324	381	413	470	533.4	584	692
E	mm	127	168	200	270	330	387	451	514	571.5	628.6	695.8	812.8
F	mm	165	210	254	318	381	445	521	584	648	711.2	774.7	914.4
K	mm	19	22	22	22	25	29	32	32	35	35	35	41.3
N	nos	8	8	8	12	12	16	16	20	20	24	24	24
AS	mm	292	356	432	559	660	787	838	889	991	1090	1194	
GS	mm	195	233	290	360	435	475	525	580	630	690	810	
B	mm	25	32	38	48	56	64	66.7	70	70	82.6	89	
C	mm	51	76	102	152	200	248	299	326.9	374.7	419.1	463.6	
D	mm	92	127	157	216	270	324	381	413	533.4	533.4	584	
E	mm	127	168	216	292	349	432	489	527	603.2	654	724	
F	mm	165	210	273	356	419	508	559	603.2	686	743	812.8	
K	mm	19	22	25	29	32	35	35	41.3	44.5	44.5	44.5	
N	nos	8	8	8	12	12	16	20	20	20	20	24	

FORGED STEEL GATE VALVES

- ANSI class 800, 1500 and 2500
- Manufactured in accordance with API 602/BS 5352
- Available in drop forged stainless steel and carbon steel
- Stellite seat / wedge offered
- IBR approved valves are also available
- Also approved in drop forged alloy steel F5, F9, F11, F22 on request

STANDARD FEATURES

Bolted Bonnet, Solid wedge gate, outside screw and yoke with rising stem.

Wedge : Ground and lapped to precision

Gland : Self aligning type.

Testing : As per API-598/BS-6755

END CONNECTIONS

- Screwed to ANSI B 2.1/BS21/IS 554/IS 554T.
- Socket weld ends to ANSI B 16.11/IS 4712.
- Flanged to ANSI B 16.5.
- Butt welded ends to ANSI B 16.25.

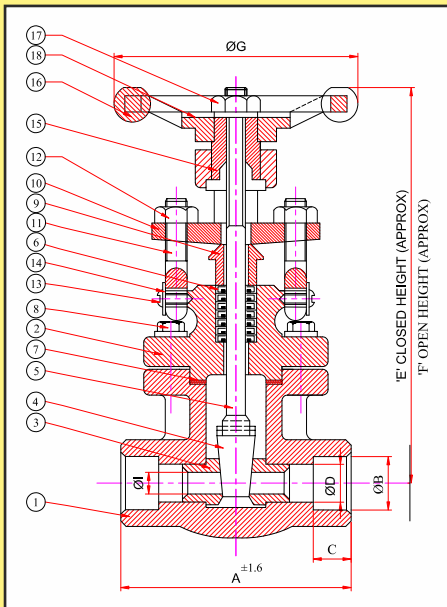

MATERIAL SPECIFICATION

SR. NO.	COMPONENT	CARBON STEEL	STAINLESS STEEL	
			SS 304	SS 316
1.	Body	ASTM A- 105	ASTMA 182-F 304	ASTMA-A 182-F316
2.	Bonnet	ASTM A- 105	ASTMA 182-F 304	ASTMA-A 182-F316
3.	Seat Ring	AISI 410 / F6	AISI 304	AISI 316
4.	Wedge	AISI 410 / F6	AISI 304	AISI 316
5.	Spindle	AISI 410 / F6	AISI 304	AISI 316
6.	Gland Packing	Graph. Asbestos with wire reinforced	PTFE / Asbestos - Grafoil to Suit service condition	
7.	Gasket	Spiral Wound SS304 with Asbestos filter	Spiral Wound SS 304 Any other gasket with asbestos filter to suit service condition	
8.	Body & Bonnet Bolt	ASTM A 193 GR B7	ASTM A 193 GR B8M	
9.	Gland Bush	AISI 410 / F6	AISI 304	AISI 316
10.	Gland Flange	ASTM A 15	As per customers requirement to suit service Condition	
11.	Eye Bolt	AISI 410 / F6	AISI 410 / F6	
12.	Eye Bolt & Nut	Carbon Steel	Carbon Steel	
13.	Set Screw	Carbon Steel	Carbon Steel	
14.	Washer	Carbon Steel	Carbon Steel	
15.	Yoke Sleeve	SG Iron / Nodular Ni- resist		
16.	Hand Wheel	Carbon Steel / SG/Iron/M.I		
17.	Hand Wheel Nut	Carbon Steel	Carbon Steel	
18.	Name Plate	Aluminum	Aluminum	

TEST PRESSURE

Hydraulic Test (Tested as per API 598/ BS 6755)						
Class	150	300	600	800	1500	2500
Body (psi)	450	1100	2175	3000	5400	9000
Seat (psi)	325	750	1500	2200	3960	6600
Air Seal (psi)	100	100	100	100	100	100

DIMENSION 'D' IS FOR SCREWED VALVES

Rating : 1 Carbon Steel ASTM A 105

150 psi at 500°F

300 psi at 800°F

600 psi at 800°F

800 psi at 800°F

2000 psi cold non- shock

1500 psi at 800°F

3600 psi cold non-stock

2500 psi at 800° F

6600 psi cold non-stock

2. Stainless ASTM A 182F304/F316

800 / 1500 / 2500 psi at 1000°F

OVERALL DIMENSION

Size	8mm	10mm	15mm	20mm	25mm	32mm	40mm	50mm
A. End to End	85	85	85	92	104	127	127	140
B. Socket Weld bore	14.1	17.5	21.7	27.1	33.8	42.5	48.6	61.1
C. Min. bore depth	9.5	9.5	9.5	12.7	12.7	12.7	12.7	16
D. Nominal bore	1/4"	3/8"	1/2"	3/4"	1"	1 1/4"	1 1/2"	2"
E. Centre to top (Closed)	146	146	146	157	166	224	224	255
F. Centre to top (Open)	159	159	159	172	189	260	260	266
G. Handwheel dia	90	90	90	90	90	150	150	150
H. End to End 150 RF			108	118	127	140	165	203
(Flanged) 300 RF			140	152	165	178	190	267
600 RF			165	190	216	229	241	292
600 RTJ			163	190	216	229	241	295
PORT dia	6.35	9.5	9.5	12.7	17.5	23.8	28.6	36

Note : Flanges according to ANSI STD B 16.5

End to End dimension according to ANSI STD B 16.10 for flanged valves.

FORGED STEEL GLOBE VALVES

- ANSI class 800, 1500 and 2500
 - Manufactured as per BS 5352
 - Available in drop forged stainless steel and carbon steel
 - IBR approved valves available
 - Stellite seat / plug offered
- Also available in drop forged alloy steel F5, F9, F11, F22 on request

STANDARD FEATURES

Plug type disc and outside screw and yoke are provided for ease of operation. Screwed or socket weld ends for class 800 valves up to 800°F, and flanged ends offered for class 600 valves up to 800°F.

SPECIAL TESTS

Optional, non-description tests offered for Gate, Globe And Check Valves

- Radiography as per ASTM code E-446
- Magnetic particle inspection as per ASTM E-125
- Dye penetrant test as per ASTM E-165
- Helium Leak Test for H2 Service Valves
- High Pressure Closer Test

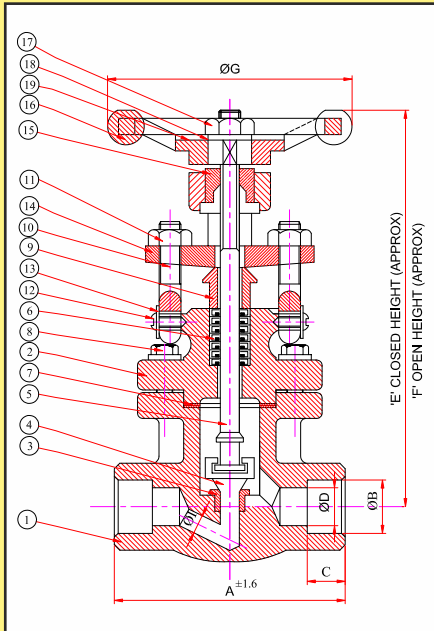

MATERIAL SPECIFICATION				
SR. NO.	COMPONENT	CARBON STEEL	STAINLESS STEEL	
			SS 304	SS 316
1.	Body	ASTM A- 105	ASTM A182-F 304	ASTM-A 182-F316
2.	Bonnet	ASTM A- 105	ASTM A 182-F 304	ASTM-A182-F316
3.	Seat Ring	AISI 410 / F6	AISI 304	AISI 316
4.	Plug	AISI 410 / F6	AISI 304 / CF8	AISI 316 / CF 8M
5.	Spindle	AISI 410 / F6	AIS 304	AISI 316
6.	Gland Packing	Graph. Asbestos with wire reinforced	PTFE / Asbestos- Grafoil to suit service conditions.	
7.	Gasket	Spiral Wound SS 304 with Asbestos filter	Spiral Wound SS 304 any other gasket with asbestos filter to suit service condition	
8.	Body & Bonnet Bolt	ASTM A 193 GR B7	ASTM A 193 GR B8M	
9.	Gland Bush	AISI 410 / F6	AISI 304	AISI 316
10.	Eye Bolt	AISI 410 / F6	AISI 410 / F6	
11.	Eye Bolt Nut	Carbon Steel	Carbon Steel	
12.	Set Screw	Carbon Steel	Carbon Steel	
13.	Washer	Carbon Steel	Carbon Steel	
14.	Gland Flange	ASTM A 105	As per customers requirement to suit service conditions.	
15.	Yoke Nut	SG Iron / Nodular Ni- resist		
16.	Hand Wheel	Carbon Steel /SC/ iRON /M.I.		
17.	Hand Wheel Nut	Carbon Steel	Carbon Steel	
18.	Hand Wheel Nut Washer	Carbon Steel	Carbon Steel	
19.	Name Plate	Aluminum	2Aluminum	

TEST PRESSURE						
Hydraulic Test (Tested as per API 598/ BS 6755)						
Cladd	150	300	600	800	1500	2500
Body (psi)	450	1100	2175	3000	5400	9000
Seat (psi)	325	750	1500	2200	3960	6600
Air Seal (psi)	100	100	100	100	100	100

DIMENSION 'D' IS FOR SCREWED VALVES

DIMENSION 'B' IS FOR SOCKET WELD VALVES

- Note :**
1. All dimension are in mm unless specified otherwise.
 2. Dimensions of size 50mm are as per manufacturers own standards.
 3. End to End dimensions according to ANSI B 16-10 for flanged valves.

OVERALL DIMENSION								
Size	8mm	10mm	15mm	20mm	25mm	32mm	40mm	50mm
A. End to End	85	85	85	92	104	127	127	140
B. Socket Weld bore	14.1	17.5	21.7	27.1	33.8	42.5	48.6	61.1
C. Min. bore depth	9.5	9.5	9.5	12.7	12.7	12.7	12.7	10
D. Nominal bore	1/4"	3/8"	1/2"	3/4"	1"	1 1/4"	1 1/2"	2"
E. Centre to top (Closed)	154	154	154	164	175	251	251	255
F. Centre to top (Open)	159	159	159	171	184	266	266	266
G. Hand Wheel dia	90	90	90	90	90	90	150	150
H. End to End 150RF			108	118	127	140	165	203
(Flanged) 300 RF			152	178	203	216	229	267
600 RF			165	190	216	229	241	292
600 RTJ			163	190	216	229	241	292
PORT dia	6.0	6.0	9.0	12.0	10.0	23	30	36

FORGED LIFT CHECK VALVES

- ANSI class 800, 1500 and 2500
- Manufactured as per BS 5352
- Constructed out of drop forged stainless steel and carbon steel
- IBR approved valves available
- Stellite seat / disc offered
- Also available in drop forged alloy steel H5, F9, F11, F22 on request

STANDARD FEATURES

Bolted Cover : Taper plug type disc and shoulder seated / pressed renewable seat ring are provided for positive seating and leak tightness. Screwed or socket weld ends are provided for class 800 and higher ratings. Class 150, 300 and 600 valves are available with flanged ends. End to End dimension are similar to Globe valves.

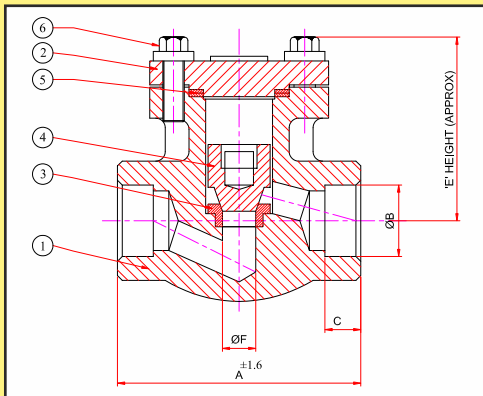

MATERIAL SPECIFICATION				
SR. NO.	COMPONENT	CARBON STEEL	STAINLESS STEEL	
			SS 304 SS316	
1.	Body	ASTM A- 105	ASTM A 182-F 304	ASTM-A 182-F316
2.	Cover	ASTM A- 105	ASTM A 182-F 304	ASTM-A 182-F316
3.	Seat Ring	AISI 410 / F6	AISI 304	AISI 316
4.	Disc	AISI 410/ F6	AISI 304 / CF8	AISI316 CF8M
5.	Gasket	Spiral Wound SS 304 with Asbestos filter	Spiral Wound SS 304 with asbestos filter to	any other gasket suit service condition
6.	Body & Bonnet Bolt	ASTM A 193 GR B7	ASTM A 193 GR B8M	

TEST PRESSURE						
Hydraulic Test (Tested as per API 598/BS 6755)						
Class	150	300	600	800	1500	2500
Body (psi)	450	1100	2175	3000	5400	9000
Seat (psi)	325	750	1500	2200	3960	6600

OVERALL DIMENSION

Size	8mm	10mm	15mm	20mm	25mm	32mm	40mm	50mm
A. End to End	85	85	85	92	104	127	127	140
B. Socket Weld bore	14.1	17.5	21.7	27.1	33.8	42.5	48.6	61.1
C. Min. bore depth	9.5	9.5	9.5	12.7	12.7	12.7	12.7	16
D. Nominal bore	1/4"	3/8"	1/2"	3/4"	1"	1 1/4"	1 1/2"	2"
E. Centre to top	56	56	56	66	74	88	88	97
F. PORT. Dia	6.0	6.0	9.0	12.0	18.0	23	30	36

Note : All dimension are in mm unless specified otherwise.
Dimension 'D' for screwed valves.

WELDED BONNET VALVES

Welded Bonnet (seal welded construction valves are specially developed by PANCHVATI for zero leakage applicable for hazardous and toxic liquid / gas. Welded Bonnet valves are ideal for preventing escape of lethal gases. PANCHVATI has already executed a few prestigious export orders amounting to more than 5000 valves.

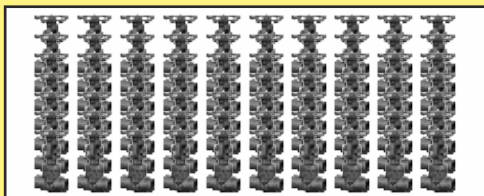

An export consignment of welded Bonnet valves for the Middle East



Welded Bonnet Gate Valves



www.panchvativalves.com

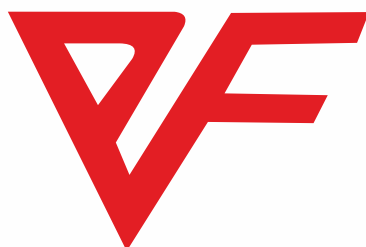

**PANCHVATI VALVES
& FLANGES PVT. LTD.**

Plot No. F-97, MIDC Area, Ambad, Nashik-422 010.

Telefax : +91-0253-6607409/6698451/52/53/54/55/56/57/58/59/60

Marketing Division :-

Sumit Samarth Arcade, 'B' Wing,

5th Floor, 503, A & B, Behind Jain Mandir

Aarey Road, Goregaon (W), Mumbai - 400 062

Phone: +91-22-26762957, Fax : +91-22-26762899

Email: panchvativalves@gmail.com / info@panchvativalves.com

Website: www.panchvativalves.com



AN ISO 9001-2008 COMPANY